

Thank You  
for this  
Initiative &  
Partnership!

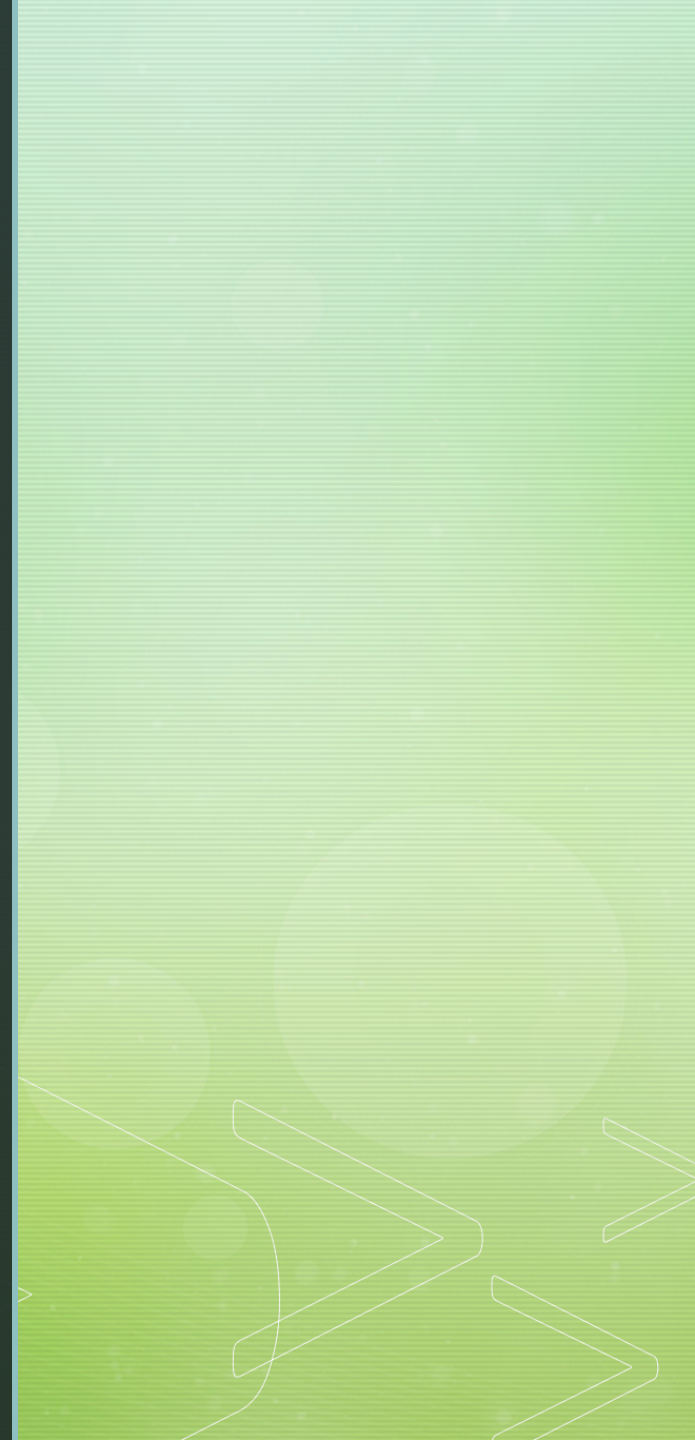

We are the SeaTac Community Coalition Composed of the More Than 40 Businesses Who Were Displaced By Transit-Oriented Redevelopment at the Commercial Mall We Built Up Over Twenty Years



Last Day at the Old Location – August 31, 2019

## Merchandise is in Costly Storage

Businesses need financial help to re-open soon and keep the tremendous economic and cultural power of Locating and Operating Together

We represent a united community of East African Immigrant Businesses and we are reaching out to other ethnic groups, such as Latinx community as well.

# Long-Term

We need to Port's help and leadership to create one or more new international markets in South King County. Saving from immigrant jobs at the airport, families are investing in businesses, but they need "incubator" space to get started just as the Pike Place Market initially provided.

PIKE PLACE MARKET INITIATIVE			
<p><b>INSTRUCTIONS TO SOLICITORS</b></p> <ol style="list-style-type: none"><li>1. Voters must be registered in City of Seattle.</li><li>2. Voters should sign EXACTLY AS REGISTERED. If the voter is registered as John B. Smith, he should sign that way and NOT J.B. Smith or other form of name.</li><li>3. Voters should fill in all spaces where possible.</li><li>4. Voters may sign Initiative Petition only once. (If voter signs once that year, the signature is not complete, and voter is subject to legal penalty).</li><li>5. Marketers pen or pencil markers pen is preferable.</li><li>6. Every name works as voters every petition no matter how few names.</li><li>7. Expense for circulating petition is prohibited by law.</li><li>8. Return of petition fee:</li></ol> <p><b>FRIENDS OF THE MARKET</b> 91 Pike St., Seattle 98101</p>	<p>Shall the City of Seattle preserve, improve, and restore the Pike Place Markets by creating a Pike Place Market Historical District and providing for administration and enforcement?</p> <p>INITIATIVE PETITION BY THE VOTERS OF SEATTLE TO THE HONORABLE CITY COUNCIL OF THE CITY OF SEATTLE, WASHINGTON:</p> <p>We, the undersigned citizens of the State of Washington and qualified electors of the City of Seattle, do hereby respectfully petition you that the proposed ordinance, a full, true and correct copy of which is on the opposite side of this petition, be enacted by the Council, or submitted to the voters of the City of Seattle, and each of us says: I have personally signed this petition; I am a qualified and legal voter of the City of Seattle and my address is correctly stated opposite my name.</p>		<p>NO. 1048</p>
<p>_____ PETITIONERS SIGNATURE (Signature Mandatory)</p>	<p>_____ PRINT NAME</p>	<p>_____ ADDRESS IN SEATTLE</p>	<p>_____ PRECINCT (If Known)</p>

In addition to serving a diverse immigrant population, an international market will meet the needs of people of color pushed south by Seattle gentrification.

*Ethnicity percentages in the Central District*

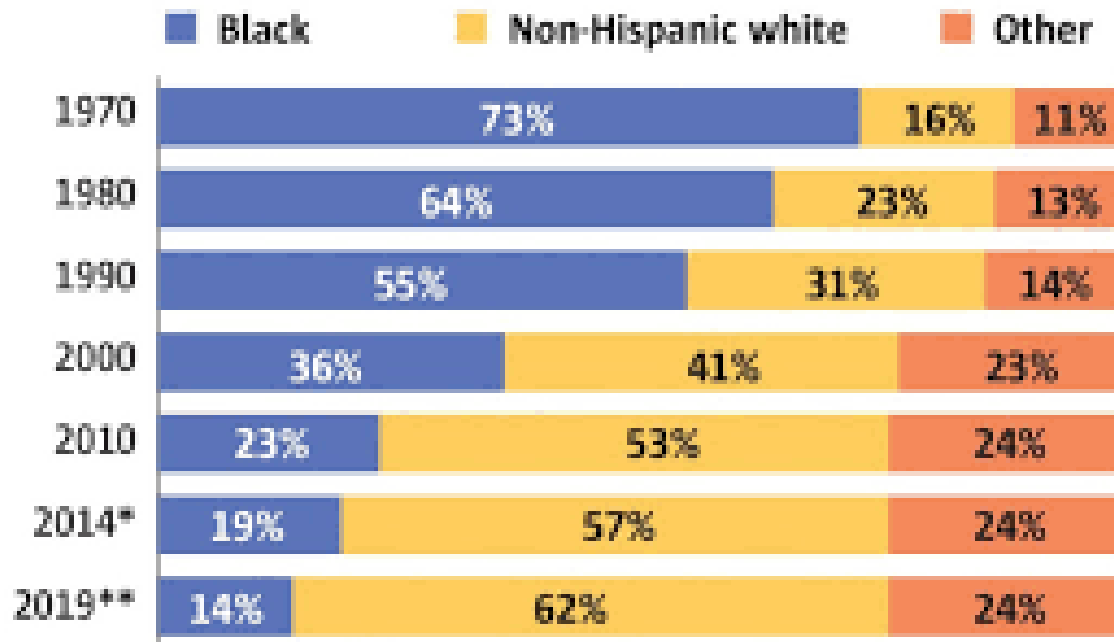

\*Estimated, \*\*Projected



### White population growing fast in South Seattle

White people have become the largest racial/ethnic group in Seattle's South End, according to the most recent census data. No group comprises a majority in the South End, which remains Seattle's most diverse area.

RACIAL/ETHNIC GROUP	PERCENTAGE	PERCENTAGE POINT CHANGE SINCE 2010
White	31.7%	3.0
Asian	30.3%	-4.2
Black	21.4%	-1.3
Latino	9.1%	2.1
Multiracial	6.0%	2.3
Pacific Islander	0.8%	-1.2
Native American	0.5%	-0.2
Other race	0.2%	-0.4

Source: U.S. Census

MARK NOWLIN / THE SEATTLE TIMES

The Public Market Initiative Must be Revived in King County  
and Follow the Leads of Other Communities

# Portland (OR) Mercado



# New York City's Essex Market (one of six public markets there)





# Cleveland's Westside Market



# Minneapolis' Midtown Market



Napa CA's Oxbow Market



A South King County Market Could Follow the **HomeSight Othello Crossing Model,**

Partitioned by a Condominium to Provide one or two floors of Commercial below with Residential above.

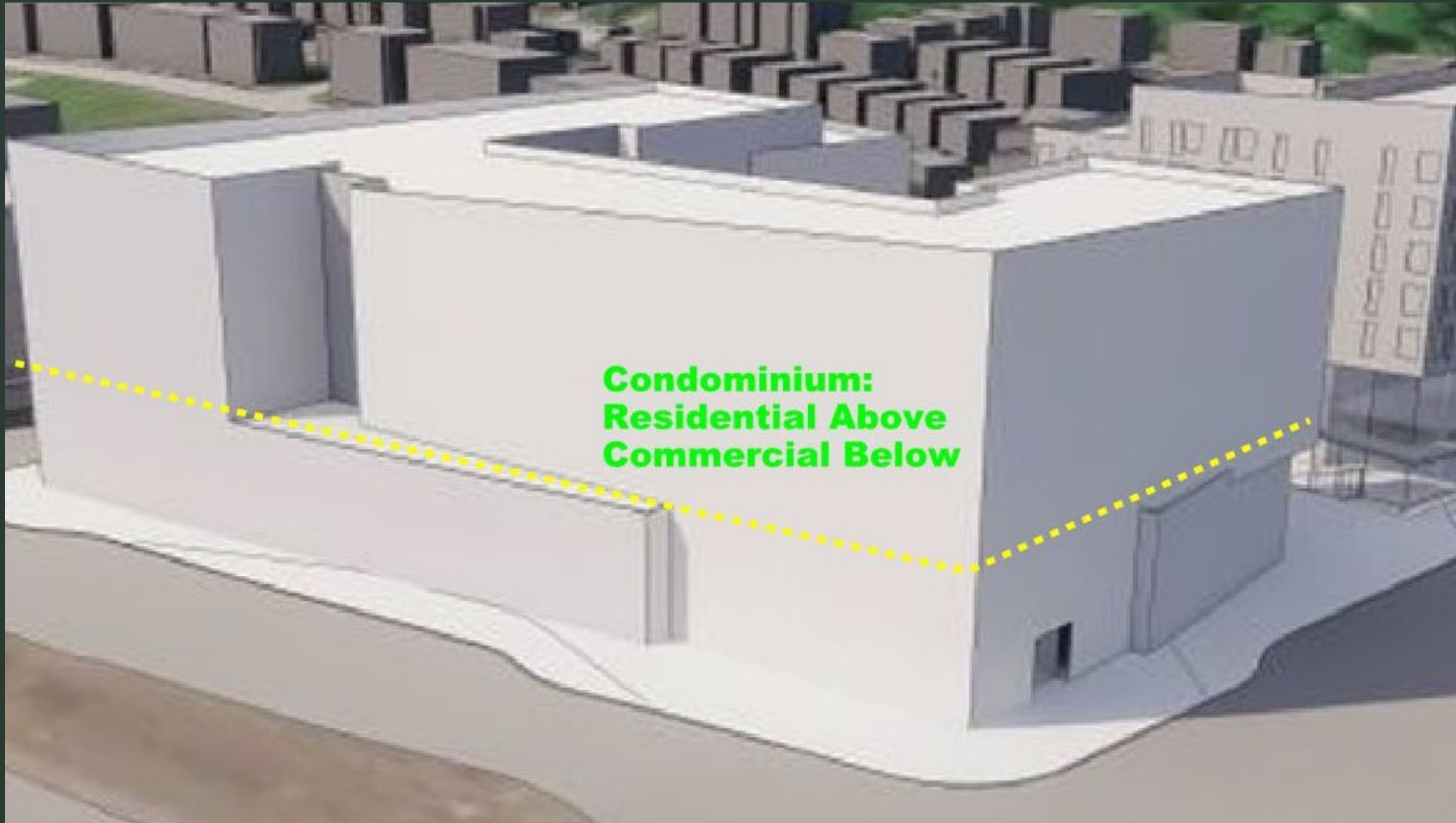

**Here is a video link to the full testimony of three displaced SeaTac East African Immigrant merchant families and a repeat of this PowerPoint with audio. [Click anywhere on the picture below to start.](#)**

